

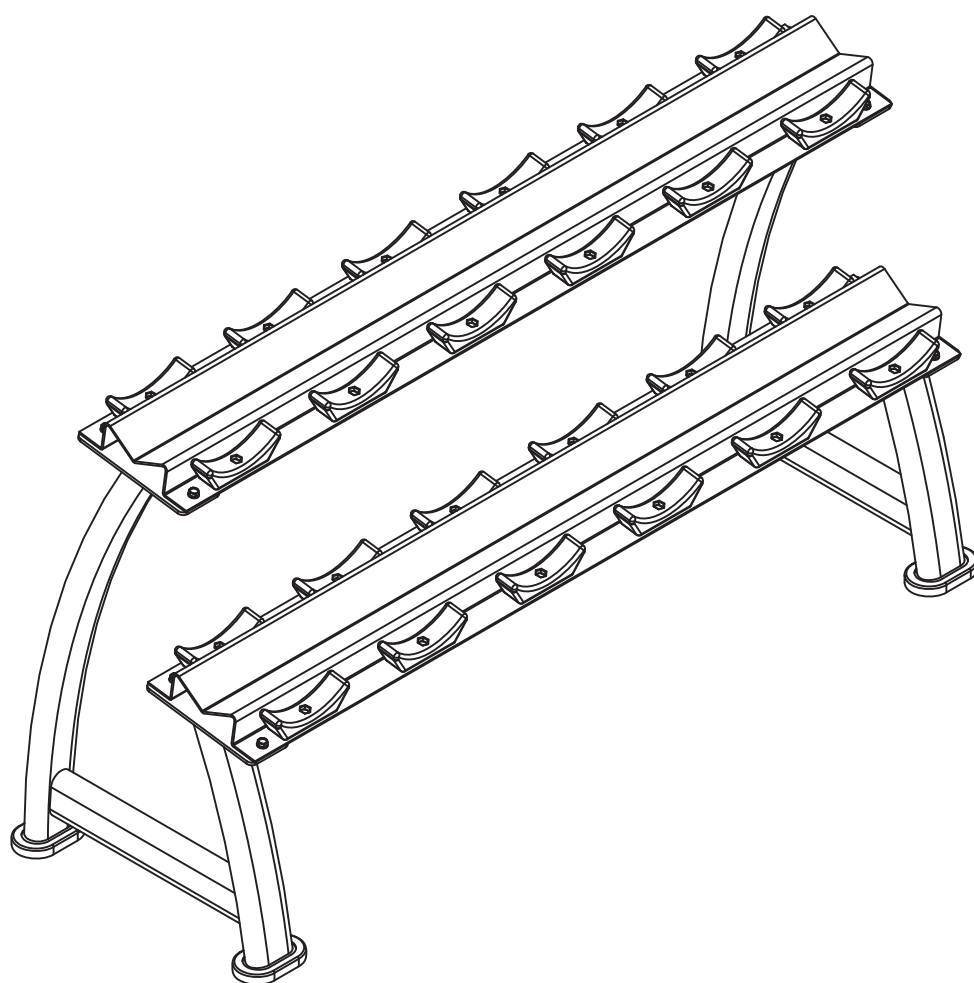

NO  
DOUBTS

SPART



**DUMBBELL RACK**

WL7102



NO  
DOUBTS

# ASSEMBLY INSTRUCTION

## I . Notice of assembly

- \* An enough dimension will be required to assemble and properly use the machine.
- \* Please use floor padding, such as cardboard, to avoid scratching your floor during assembly.
- \* The nuts and bolts have a little grease on them to protect them from corrosion. Please keep a rag handy to wipe your hands.
- \* All plastic end caps and plugs have been assembled on the unit prior to shipment. They are shown on the assembly drawings for reference in the event replacement parts are needed.
- \* The machine uses several different lengths of bolts. Be careful to use the correct length of bolt called for at each step of assembly.
- \* Do not touch the wires and cables attention when drilling.

## II . Before you begin

Locate a comfortable work site. Assemble your machine in an open space with ventilation and lighting, and with the help of other person. The machine posses a large area, so you do not place it in living room.

Find your tools. You will need the following tools to assemble your machine.

- . Standard screwdriver
- . WD40 lubricant or Vaseline (if necessary)

## III . Assembling your machine

## EXPLODED DRAWING

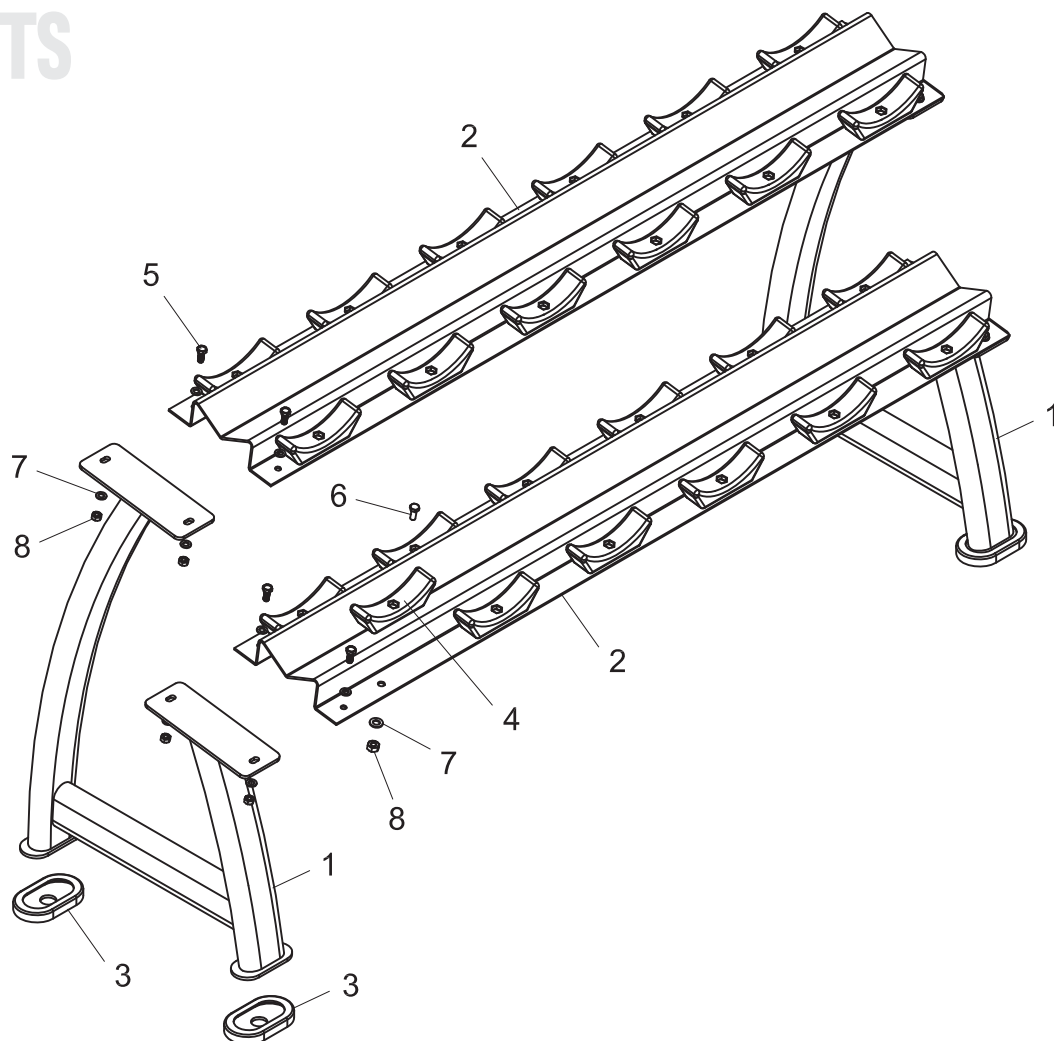

NUMBER	DESCRIPTION	QUANTITY
1	MAIN FRAME	2
2	MAIN SUPPORT	2
3	RUBBER PAD	4
4	POSITIONING BLOCK	24
5	BOLT M8*20	8
6	BOLT M8*25	24
7	WASHER 8	40
8	LOCK NUT M8	32

**www.zunfit.com**



**ITALY OFFICE**

Zun Srl  
via Mammarella snc  
66100 Chieti Scalo (CH), Italy  
Email: [info@zunfit.com](mailto:info@zunfit.com)  
Phone: +39 0871 551762

**CHINA OFFICE**

Zunone  
83# South Tongfu Road,  
Nantong Jiangsu China  
Email: [simon@zunone.cn](mailto:simon@zunone.cn)  
Phone: +0086-13901602295